

## Medidas

### Grifo Mural

Referencia	Largo Frente	Ancho Fondo	h1	h2	h total	Peso +/-	Peso Bandeja	Peso Total	Seno	Material	Acabados
30.600.450.40.1.1	600	450	40	22	62	24,84	5	29,84	Centro	Caliza	Apomazado
30.600.450.30.2.2	600	450	30	22	52	18,63	5	23,63	Centro	Pizarra	Arenado
30.800.450.40.1.1	800	450	40	22	62	33,12	5	38,12	Centro	Caliza	Apomazado
30.800.450.40.2.2	800	450	30	22	52	24,84	5	29,84	Centro	Pizarra	Arenado
30.1000.450.40.1.1	1000	450	40	22	62	41,40	5	46,40	Centro	Caliza	Apomazado
30.1000.450.30.2.2	1000	450	30	22	52	31,05	5	36,05	Centro	Pizarra	Arenado
30L.1000.450.40.1.1	1000	450	40	22	62	41,40	5	46,40	Izquierda	Caliza	Apomazado
30L.1000.450.30.2.2	1000	450	30	22	52	31,05	5	36,05	Izquierda	Pizarra	Arenado
30R.1000.450.40.1.1	1000	450	40	22	62	41,40	5	46,40	Derecha	Caliza	Apomazado
30R.1000.450.30.2.2	1000	450	30	22	52	31,05	5	36,05	Derecha	Pizarra	Arenado
30.1200.450.40.1.1	1200	450	40	22	62	49,68	5	54,68	Centro	Caliza	Apomazado
30.1200.450.30.2.2	1200	450	30	22	52	37,26	5	42,26	Centro	Pizarra	Arenado

### Grifo sobre Encimera

Referencia	Largo Frente	Ancho Fondo	h1	h2	h total	Peso +/-	Peso bandeja	Peso Total	Seno	Material	Acabados
31.600.450.40.1.1	600	450	40	22	62	24,84	5	29,84	Centro	Caliza	Mate
31.600.450.30.2.2	600	450	30	22	52	18,63	5	23,63	Centro	Pizarra	Arenado
31.800.450.40.1.1	800	450	40	22	62	33,12	5	38,12	Centro	Caliza	Mate
31.800.450.40.2.2	800	450	30	22	52	24,84	5	29,84	Centro	Pizarra	Arenado
31.1000.450.40.1.1	1000	450	40	22	62	41,40	5	46,40	Centro	Caliza	Mate
31.1000.450.30.2.2	1000	450	30	22	52	31,05	5	36,05	Centro	Pizarra	Arenado
31L.1000.450.40.1.1	1000	450	40	22	62	41,40	5	46,40	Izquierda	Caliza	Mate
31L.1000.450.30.2.2	1000	450	30	22	52	31,05	5	36,05	Izquierda	Pizarra	Arenado
31R.1000.450.40.1.1	1000	450	40	22	62	41,4	5	46,40	Derecha	Caliza	Mate
31R.1000.450.30.2.2	1000	450	30	22	52	31,05	5	36,05	Derecha	Pizarra	Arenado
31.1200.450.40.1.1	1200	450	40	22	62	49,68	5	54,68	Centro	Caliza	Mate
31.1200.450.30.2.2	1200	450	30	22	52	37,26	5	42,26	Centro	Pizarra	Arenado

### Piedras y Texturas

Caliza



Pizarra



Apomazado



Arenado



### Accesorios

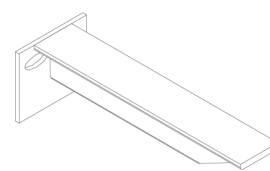
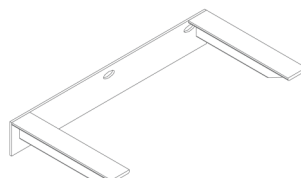
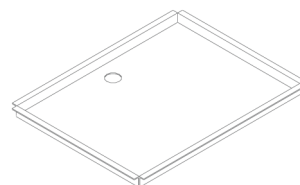
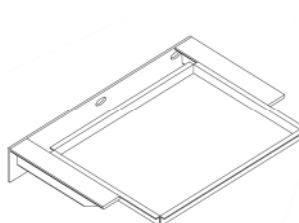

# Piatta

## Grifo Mural

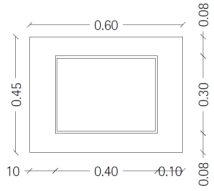

Ref.: 30.600.450.40.1.1

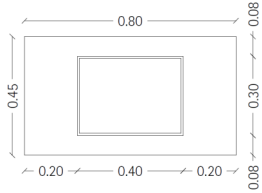
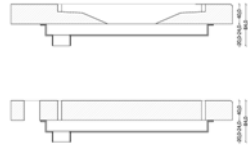

Ref.: 30.800.450.40.1.1

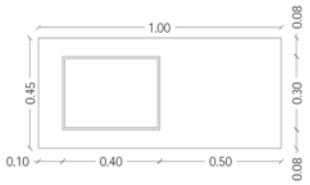
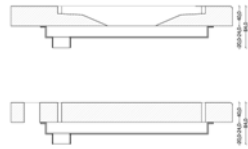

Ref.: 30L.1000.450.40.1.1

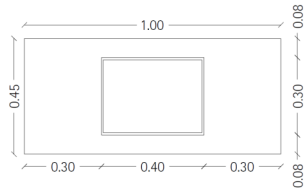
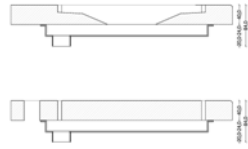

Ref.: 30.1000.450.40.1.1

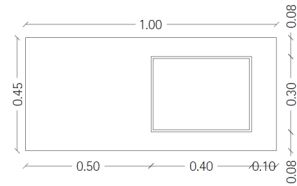
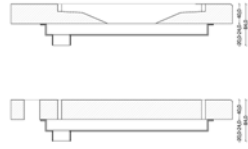

Ref.: 30R.1000.450.40.1.1

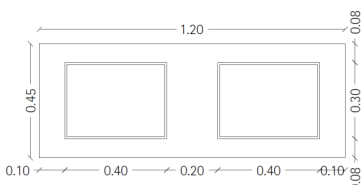
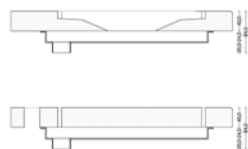

Ref.: 30.1200.450.40.1.1

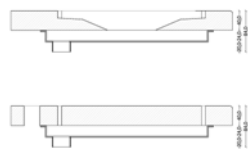

## Grifo sobre Encimera

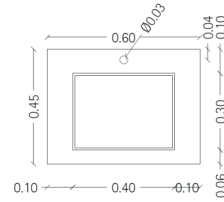

Ref.: 31.600.450.40.1.1

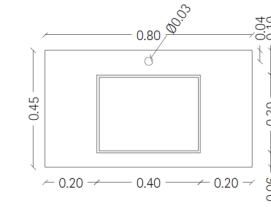
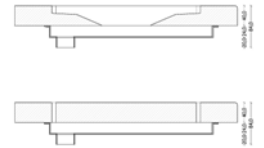

Ref.: 31.800.450.40.1.1

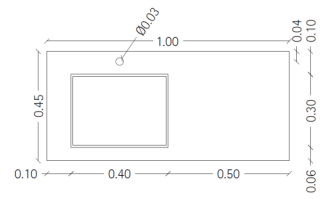
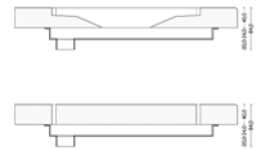

Ref.: 31L.1000.450.40.1.1

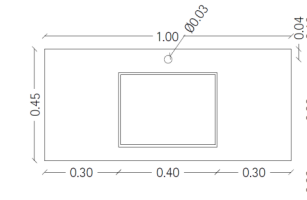
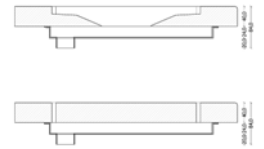

Ref.: 31.1000.450.40.1.1

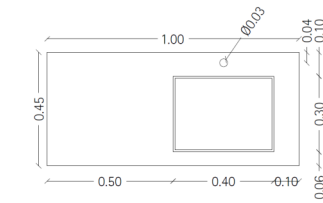
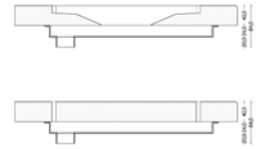

Ref.: 31R.1000.450.40.1.1

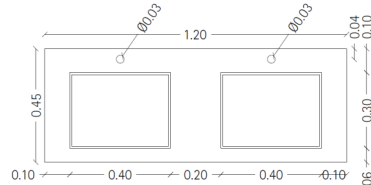
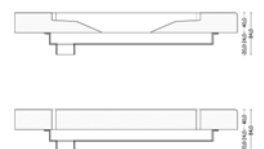

Ref.: 31.1200.450.40.1.1

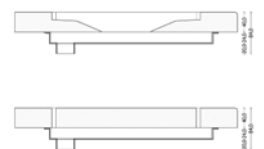

# Piatta

## Grifo Mural

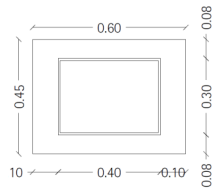

■ ■■■ Ref.: 30.600.450.30.2.2

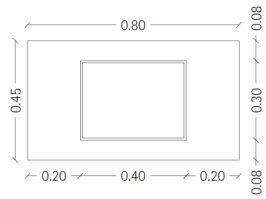

■ ■■■ Ref.: 30.800.450.30.2.2

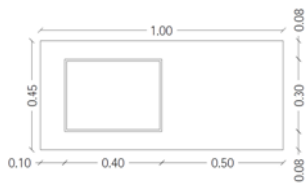

■ ■■■ Ref.: 30L.1000.450.30.2.2

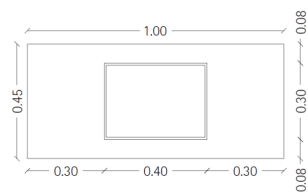

■ ■■■ Ref.: 30.1000.450.30.2.2

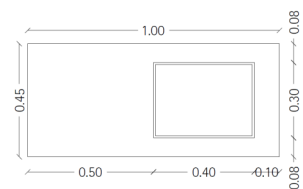

■ ■■■ Ref.: 30R.1000.450.30.2.2

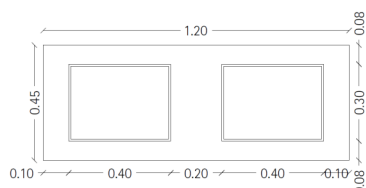

■ ■■■ Ref.: 30.1200.450.30.2.2

## Grifo sobre Encimera

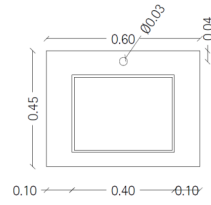

■ ■■■ Ref.: 31.600.450.30.2.2

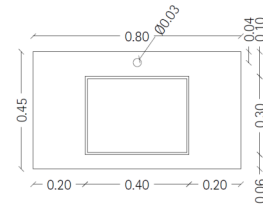

■ ■■■ Ref.: 31.800.450.30.2.2

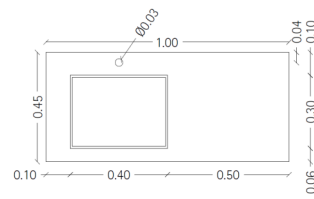

■ ■■■ Ref.: 31L.1000.450.30.2.2

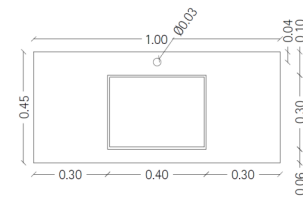

■ ■■■ Ref.: 31.1000.450.30.2.2

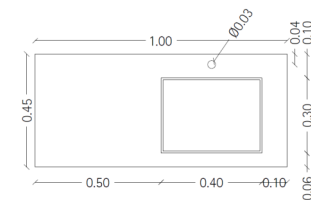

■ ■■■ Ref.: 31R.1000.450.30.2.2

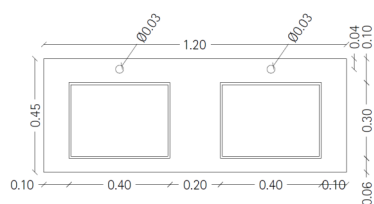

■ ■■■ Ref.: 31.1200.450.30.2.2